

SHOW THE BIGGER PICTURE!

Architecture is an experience. Surface 400 strives to communicate that experience through video and still photography. Why should you trust your imaging to us? Because we believe in showing the bigger picture!

Cell phone and entry level DSLR cameras are marvels of innovation, but they only capture a portion of a space in their narrow field of view. In the 12' x 16' bedroom example below, our Professional DSLR camera is able to capture 82% of the room (slightly more than the 76% the human eye can see). In contrast, an entry level DSLR camera with its cropped APS-C sensor can only capture 44% of the room, and the iPhone 6s captures even less at 39%.

Let Surface 400 communicate an accurate and true to life experience with the right camera equipment to film or shoot your property!

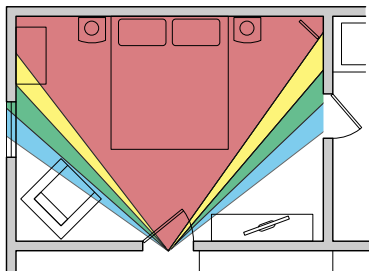

Field of View Comparison

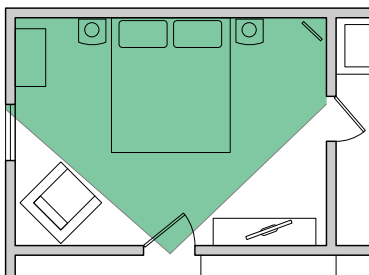

Human Eye

Lens - 20 mm (equivalent)
 Field of View - 95°

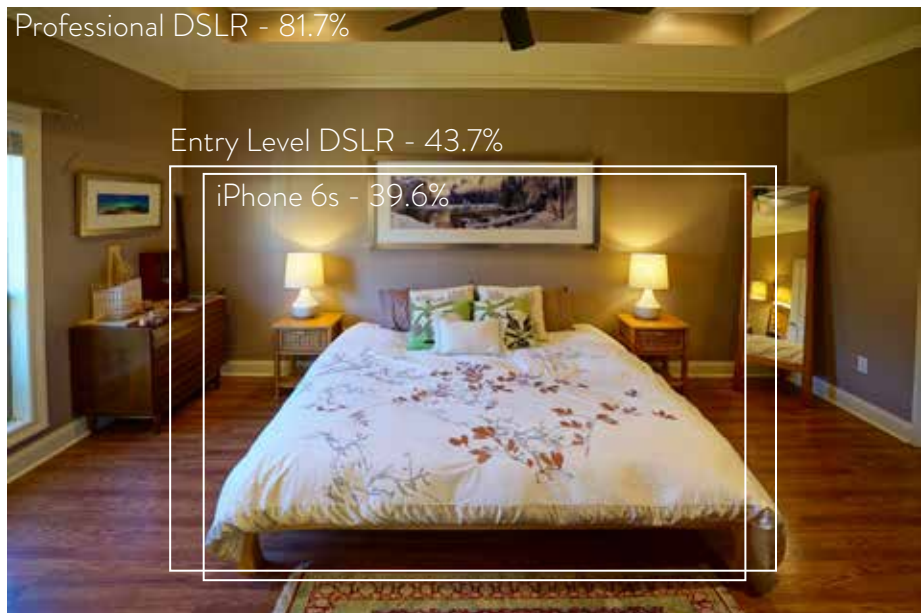

How much does your camera capture?

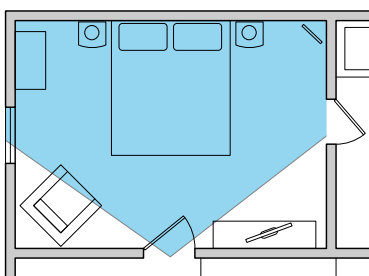

Professional DSLR*

Lens - 16 mm
 Field of View - 107°
 *Full frame sensor

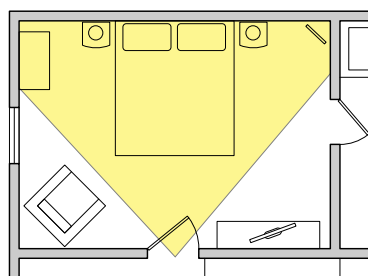

Entry Level DSLR*

Lens - 16 mm
 Field of View - 83°
 *APS-C sensor

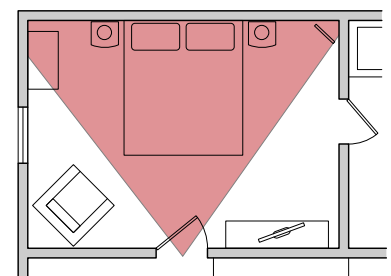

iPhone 6s

Lens - 30 mm (equivalent)
 Field of View - 73°